

LIDIJA BAKARIĆ
Arheološki muzej u Zagrebu
Trg Nikole Šubića Zrinskog 19
HR – 10000 Zagreb
lbakaric@amz.hr

IVA KOSTEŠIĆ
Veleučilište Baltazar Zaprešić
Vladimira Novaka 23
HR – 10290 Zaprešić
ivakostesic@gmail.com

SANJIN MIHELIC
Arheološki muzej u Zagrebu
Trg Nikole Šubića Zrinskog 19
HR – 10000 Zagreb
smihelic@amz.hr

NERA ŠEGVIĆ
Ksaverska 79
HR – 10000 Zagreb
Nera.segvic@gmail.com

Sondažna istraživanja crkve sv. Marka u Širokoj luci kod Plitvica Sela

Sondage excavations of St. Mark's church in Široka luka near Plitvica Selo

UDK: 904:726.54(497.5 Plitvica Selo)

Izvorni znanstveni rad/Original scientific paper

Tijekom razdoblja 2011.–2013. g. AMZ je vršio rekognosciranja i manja sondažna istraživanja na užem i širem području Nacionalnog parka Plitvička jezera. Sondažna istraživanja poduzeta su i u Širokoj luci kod Plitvica Sela, na lokaciji crkve sv. Marko. Djelomično su otkriveni temelji crkve, kao i dio pratećeg groblja. Ustanovljeno je da je crkva spomenuta na habsburškim, a i drugim geografskim kartama kao »stara crkva«.

Ključne riječi: Plitvička jezera, Plitvica Selo, Rodić Poljana, crkva sv. Marka, srednji vijek

Between 2011 and 2013, the Archaeological Museum in Zagreb carried out reconnaissance surveys and small-scale sondage excavations in the inner and broader area of the Plitvice Lakes National Park. The sondage excavation at the church of St. Mark in Široka luka near Plitvica Selo yielded the remains of a part of the foundations of a church and a part of the adjoining graveyard. It was established that the church was marked on maps from the Habsburg period, as well as other geographic maps, as "old church".

Key words: Plitvice Lakes, Plitvica Selo, Rodić Poljana, St. Mark's church, Middle Ages

Uvod

U okviru projekta *Istraživanje, prezentacija i turistička valorizacija arheološke baštine Nacionalnog parka Plitvička jezera 2011.–2013. g.*¹ izvršena su rekognosciranja i manja sondažna istraživanja na užem i širem području Nacionalnoga parka Plitvička jezera (u daljnjem tekstu Park).² Sondažna istraživanja poduzeta su i u Širokoj luci kod Plitvica Sela, na pretpostavljenoj lokaciji crkve sv. Marka.³

Plitvička jezera proglašena su 1949. g. nacionalnim parkom, a 1979. g. uvrštena su na UNESCO-v popis svjetske kulturne i prirodne baštine. U tih 60 i više godina dogodile su se mnoge promjene u životu toga područja. Da bi se sačuvao ekosustav jezera, preusmjeren je promet vozila s ceste na samim jezerima na primjereniju lokaciju. Sav promet smanjen je na minimum, šume i livade, odnosno biljni pokrov, preuzeo je većinu površine Parka, zabranjena je upotreba pesticida i bilo kakvih kemikalija na obradivim površinama zemljišta, djelomično je zabranjen i uzgoj

¹ Nositelji projekta su Lidija Bakarić i Sanjin Mihelić, Arheološki muzej u Zagrebu. Ekipu su sačinjavali: Iva Kostešić, Nera Šegvić, Ana Franjić, Ana Đukić, Paula Androić, studenti arheologije i diplomirani arheolozi. Projekt je u cijelosti financirao Nacionalni park Plitvička jezera.

² U pripremama za rekognosciranje Parka korištena je brojna literatura, izvještaji, prostorni plan, te razne geografske karte. Svojim savjetima pomogli su od strane Parka stručna voditeljica Antonija Dujmović, stručni voditelj Anđelko Novosel, te dipl. arh. Katica Teklić, kao i rendžeri, koji poznaju teren i uvijek su bili spremni pomoći. Kolega Amelio Vekić iz Konzervatorskog odjela u Zagrebu, Uprave za zaštitu kulturne baštine Ministarstva kulture, ustupio nam je njemu dostupnu dokumentaciju o Parku, koju je koristio prilikom izrade Prostornog plana. Vrijedni su nam bili i savjeti Tajane Pleše iz Odjela za kopnenu arheologiju Hrvatskog restauratorskog zavoda, a dio literature ustupila nam je Martina Ivanuš iz Konzervatorskog odjela u Gospiću. Posebno bi se zahvalili obitelji Rodić iz Rodić Poljane, vlasnicima zemljišta u Širokoj luci, na susretljivosti, korisnim savjetima, te na dozvoli za istraživanje. Obitelj Sertić iz Sertić Poljane, također vlasnici zemljišta u Širokoj luci, dala nam je korisne informacije o svojem zemljištu, na čemu im najljepše zahvaljujemo. Zahvaljujemo i brojnim kolegama koje smo konzultirali prilikom rekognosciranja terena. Zahvaljujemo i Jannie Rapaić Jonker, koja odlično poznaje sve puteljke koji vode kroz Park, i koja je zaslužna na uvijek dobroj atmosferi cijele ekipe.

³ Stručni arheološki nadzor obavili su Dalibor Šušnjić iz Konzervatorskog odjela u Gospiću, a od strane Parka dipl. arh. Katica Teklić.

Introduction

As part of the project *Research, Presentation and Tourist Evaluation of the Archaeological Heritage of the Plitvice Lakes National Park 2011–2013*,¹ reconnaissance surveys and small-scale sondage excavations were carried out in the inner and broader area of the Plitvice Lakes National Park (referred to as the Park further in the text).² One such sondage excavation was carried out in Široka luka near Plitvica Selo, at the presumed site of St. Mark's church.³

In 1949, the Plitvice Lakes were designated a national park, and in 1979 the Lakes were included on UNESCO's World Cultural and Natural Heritage List. A number of changes took place in the life of this area during the past 60 years. In order to preserve the ecosystem of the Lakes, vehicle traffic was redirected from the Lakes to a more

¹ The project was managed by Lidija Bakarić and Sanjin Mihelić from the Archaeological Museum in Zagreb. The team consisted of Iva Kostešić, Nera Šegvić, Ana Franjić, Ana Đukić, Paula Androić, students and graduate archaeologists. The project was funded by the Plitvice Lakes National Park.

² In preparing for the reconnaissance surveys in the Park, we made an extensive use of the available literature, reports, spatial plans and a variety of geographical maps. We received helpful advice from the staff of the Park, the Service Heads Antonija Dujmović and Anđelko Novosel, and the Head of the Department for the Protection of Cultural Heritage, Katica Teklić, as well as from the rangers, who are familiar with the terrain and were always ready to help. Our colleague Amelio Vekić from the Zagreb Conservation Department of the Service for the Protection of Cultural Heritage of the Ministry of Culture shared with us the documentation available about the Park, which he used to create the spatial plan. We also received valuable advice from Tajana Pleše from the Department for Land Archaeology of the Croatian Conservation Institute, while Martina Ivanuš from the Conservation Department in Gospić gave us a part of the relevant literature. We wish to express our special gratitude to the Rodić family from Rodić Poljana, the owners of the land in Široka luka, for their friendliness, helpful advice and permission to excavate. The Sertić family from Sertić Poljana, the other owners of the land in Široka luka, provided valuable information about their plot, for which we are very grateful. We would also like to thank a number of our colleagues whom we consulted during our reconnaissance surveys of the area, as well as Jannie Rapaić Jonker, who is extremely knowledgeable about all the paths through the Park and to whom we are grateful for the permanent good atmosphere in the team.

³ The archaeological supervisors were Dalibor Šušnjić from the Conservation Department in Gospić, and the architect Katica Teklić from the Park.

domaćih životinja (poglavito goveda), što je kao posljedicu imalo veliko raseljavanje stanovništva. U konačnici, preostalo stanovništvo bavi se pretežno turizmom, a minimalno obradom zemljišta i poljoprivredom. Uslijed navedenog, ekipa Arheološkog muzeja u Zagrebu imala je brojne probleme u prepoznavanju arheoloških lokaliteta na području Parka. Većina šireg područja Parka prekrivena je šumom, u kojoj otpalo lišće čini do 0,60–0,70 cm dubine zemljanog pokriva. U takvim okolnostima, vizualnim pregledom zemljišta vrlo je teško otkriti eventualne pokretne i nepokretne arheološke nalaze kao dokaz prošle ljudske djelatnosti. Malobrojno stanovništvo, koje je nakon 1949. godine nastavilo živjeti na širem području Parka, raspolaže s vrlo malo saznanja o životu u tom kraju prije turskih osvajanja, te u vrijeme i nakon osvajanja do danas. Prekid tradicije i usmene predaje može se protumačiti burnom prošlošću ovoga područja, kao i naseljavanjem izbjeglog stanovništva za vrijeme i nakon turske okupacije. Većina lokacija i naselja u Parku nose rodovska imena (npr. Rodić Poljana), dok neka nose imena prema karakteristikama kraja (npr. Plitvica Selo),⁴ a toponimi, kao npr. *Gradina*, *Gradac* i slično, koji bi upućivali na moguće povijesne lokalitete, gotovo u potpunosti nedostaju.⁵ To ukazuje na nestanak takozvanoga kolektivnoga sjećanja u tom kraju, a uzrok tome je učestalo povijesno raseljavanje lokalnoga stanovništva.

U srednjovjekovnom razdoblju područje Parka nalazilo se u sklopu Drežničke županije. Krajem 15. st. počinju upadi i pljačke tog područja od strane Turaka, a 1527. g. Liku i Krbavu u potpunosti osvajaju te one padaju pod Osmansko Carstvo. Sama Jezera, kao i dio Korane, neko su vrijeme bila granica između Habsburške Monarhije i Osmanskog Carstva. Na povijesnim zemljovidima obilježeni su brojni čardaci duž te granice.⁶ Dolaskom Turaka te uslijed stalne opasnosti, stanovništvo je izbjeglo, područje su naselili razbojnici, a područje su prekrile guste šume.

Područje je oslobođeno 1689. g., nakon čega je 1699. mirom u Srijemskim Karlovcima utvrđena granica između Habsburške Monarhije i Osman-

appropriate location. Traffic has been limited to a minimum, while forests and meadows, i.e. vegetation has taken over most of the territory of the Park. The use of pesticides and any other chemical substances on cultivated land was forbidden, and the breeding of domestic animals (cattle in particular) was also prohibited in part, which resulted in the mass relocation of the population. As the end result of all this, the remaining population mainly engages in tourism, while land cultivation and agriculture play a very minor role. Due to this, the team of the Archaeological Museum in Zagreb encountered a number of problems in its search for archaeological sites in the Park. Most of the broader area of the Park is covered with forest, in which fallen leaves make up 0.60–0.70 cm of the topsoil. In such circumstances, it is very difficult to spot any movable or immovable archaeological finds as evidence of past human activity through visual inspection of the environment. The scanty population that remained living in the broader area of the Park after 1949 has very limited knowledge about life in that area prior to the Turkish conquest, as well as of the time during and after the conquest to present day. The break in tradition and oral tradition may be interpreted as a result of the turbulent history of this area, as well as of the immigration of refugees during and after the Ottoman occupation. Most of the locations and settlements in the Park bear family names (e.g. Rodić Poljana), while some were named after the features of the land (e.g. Plitvica Selo),⁴ while toponyms such as e.g. *Gradina*, *Gradac* and similar names that might indicate potential historical sites are almost entirely absent.⁵ This points to the disappearance of so-called collective memory in this area, caused by the frequent emigration of local residents through history.

During the Middle Ages, the territory of the Park formed part of the Drežnik County. The end of the 15th century marks the beginning of Turkish incursions and raids in this area, and the Lika and Krbava regions were completely conquered in 1527, whereupon they were incorporated into the Ottoman Empire. The Lakes themselves, as well as a part of the Korana river, for some time marked the border between the Habsburg Monar-

⁴ Čulinović-Konstantinović 1974, 177.

⁵ Izuzev Gradine Krčingrad i Gradinskog jezera.

⁶ Horbec 2008, 11.

⁴ Čulinović-Konstantinović 1974, 177.

⁵ Except the Krčingrad hillfort and the Gradina Lake.

skog Carstva. Tada je cijeli plitvički kraj ostao na hrvatskoj strani.⁷

Krajem 17. st. područje je bilo prekriveno gustim šumama, koje su doseljenici (pravoslavci i katolici⁸), radi ispaše stoke počeli krčiti, a kasnije su formirali i svoja naselja. Novi doseljenici nisu poznavali povijest i predaje kraja, te je kolektivno sjećanje zauvijek izgubljeno. Od predaja se sačuvala samo ona o Krčingradu ili Plišu iznad Gradinskog jezera i Crnoj kraljici, te o ruševinama »grčke« crkve kod Plitvica Sela.

Povijest istraživanja

Prostor današnjeg Parka slabo je obrađen u arheološkoj literaturi. Pregled terena od strane arheologa vršen je u nekoliko navrata, u novije vrijeme povodom izrade prostornog plana Parka.⁹

U posljednjih nekoliko godina arheološki je djelomično istražen lokalitet Gradina, poluotok kod Gradinskog jezera. Istražena je trokutasta branič kula te dio ograde – bedema, koji su datirani u 13.–14. st.¹⁰ Druga istraživanja na području Parka nisu poduzimana.

Ekipe Muzeja provjerila je registrirane lokalitete iz Prostornog plana, te otkrila i nekoliko novih.

Dosadašnja saznanja o crkvi sv. Marka

Prilikom izvršavanja plana projekta *Istraživanja, prezentacija i turistička valorizacija arheološke baštine Nacionalnog parka Plitvička jezera 2011.–2013. g.* veći dio vremena posvećen je istraživanju crkve sv. Marka u Širokoj luci kod Rodić Poljane, koja je u sastavu Plitvica Sela.

Prvi spomen crkve nalazimo na karti koju je na-

chy and the Ottoman Empire. A number of blockhouses are marked on historical maps along this border.⁶ Upon the arrival of the Turks and due to the constant danger, the residents fled, the area was settled by outlaws, and the entire territory was covered with dense forests.

This area was liberated in 1689, whereupon the border between the Habsburg Monarchy and the Ottoman Empire was established by the Treaty of Karlowitz in 1699, leaving the entire area of Plištvice on the Croatian side.⁷

At the end of the 17th century, the area was covered in dense forests, which the new population (both Orthodox and Catholic⁸) started clearing to create pastures for their cattle, and where later they formed their settlements. The immigrants did not know the history and traditions of the land, and the collective memory was lost forever. Only the tradition about Krčingrad or Pliš above the Gradina Lake and the Black Queen remained preserved, as well as the tradition about the ruins of the “Greek” church near Plitvica Selo.

Research history

The territory of the present-day Park is not very well represented in the archaeological literature. Archaeologists surveyed the area on several occasions, the latest of which took place recently, during the creation of a spatial plan of the Park.⁹

Over the last several years, archaeological investigations were carried out on a part of the Gradina site on the peninsula at the Gradina Lake. A triangular keep and a part of the fortifying wall

⁷ Horbec 2008, 11.

⁸ Franić 1910, 300.

⁹ Vekić 2011. Ružica Drechsler Bižić bila je nositelj znanstvenog projekta Centra za povijesna istraživanja Sveučilišta u Zagrebu, Odjel za arheologiju »Istraživanja naselja i kultura prethistorijskog, antičkog i srednjovjekovnog razdoblja u SR Hrvatskoj i izrada Arheološke karte Hrvatske« od 1986. – 1990. (Projekt br. 78.). Tijekom 1988. g. u okviru projekta vršeno je rekognosciranje Parka. Rezultati rekognosciranja nisu objavljeni, a izvještaj o radu (Arhiv AMZ-a) korišten je za vrijeme pisanja ovog rada. Projekt je spomenut u radu Kolak, Šušnjić 2008, 209–210.

¹⁰ Pleše 2010, 2011.

⁶ Horbec 2008, 11.

⁷ Horbec 2008, 11.

⁸ Franić 1910, 300.

⁹ Vekić 2011. Ružica Drechsler Bižić was the head of the research project of the Centre for Historical Research of the University of Zagreb, Department of Archaeology, “Study of Settlements and Cultures of the Prehistoric, Antique and Mediaeval Periods in SR Croatia and the Creation of the Archaeological Map of Croatia” between 1986 and 1990 (Project no. 78). The area of the Park was surveyed in 1988 as part of the work on the project. The results of the survey were not published, and the report (Archives of the AMZ) was used for the creation of this paper. The Project was mentioned in the article by Kolak, Šušnjić 2008, 209–210.

pravila Habsburška Monarhija prilikom prve topografske i vojne izmjere, pod nazivom *Karlovac u vremenu od 1774. –1775.*¹¹ Crkva je obilježena kao »*Alte Kirch*«. Na Jeney-Božićevoj karti iz 1780. godine, kod izvora potoka Plitvice, ubilježena je kao »*alte Kirche*«. ¹² Karlovački školski nadzornik, Franjo Julije Fras, 1835. g. piše da kod potoka Plitvice postoje još tragovi nekadašnjeg grčkog hrama. ¹³ Kamenko Delić, autor knjige »*Plitvička jezera i njihova okolina*«, 1899. piše da se nedaleko od izvora potoka Plitvice, a ispod kuća Rodićevih, u dolini vidi temelj jedne crkve, te da je tu blizu i pećina. ¹⁴ Nadalje, Kamenko Delić piše da mještani Plitvica Sela, prezimena Grbić, govore da je tu doista bila »*grčka crkva*«, jer da je i ovaj cijeli kraj po kazivanju njihovih starih – nekada bio »*grčki*«. Oni crkvu zovu *Crkvina Luke*¹⁵ kod Plitvice. U knjizi je priložen i (vrlo neuobičajen) tlocrt crkve s dimenzijama (sl. 1). »*Ja sam našao, da je ona imala ovaj položaj. Južni se temelj dobro raspoznaje; dug je između 18–19 m. Istočni je dio zaokružen i dobro se sačuvao; tu je bio oltar, a širina mu je 6–7 m. Sjeveroistočni se temelj ne vidi, jer je mnogo kamenje ondje naslagano; ali mislim da je išao paralelno s jugoistočnim krajem. Ujedno se vidi ovdje, ali se teško razabira, da je još nekakva zida bilo, može biti da su to bile sobe ili ćelije za svećenike. Zapadni se kraj ne razaznaje, ali se čini kao da je stajao tu toranj. ...U samoj okolini nađe se otesana sedrena kamenja; a taki je i u temelju.... Odmah je tu uz Crkvinu ozidan most preko potoka Plitvice, pa načinjen je stari put na Prijeku Kosu i dalje u Babin Potok. Kad se ovdje krčilo, nalazili su ljudi uz ovaj put noževa, sabalja i različitih gvozdarija....*«, »*Oko crkve nalazilo se i grčkih natpisa na kamenu, ali je to sve propalo. Uz Crkvinu je, istočno od nje, mjesto, gdje su novci bili zakopani, ali su te novce neki Grci poslije odnijeli. Jugoistočno od Crkvine bila je jedna pećina, a sada je već gotovo sasva zatrpana. O njoj priča ovaj Dane, da je slušao od pokojnog djeda Alekse, da kad su Grci odavde pobjegli, da su odežde [=mi-*

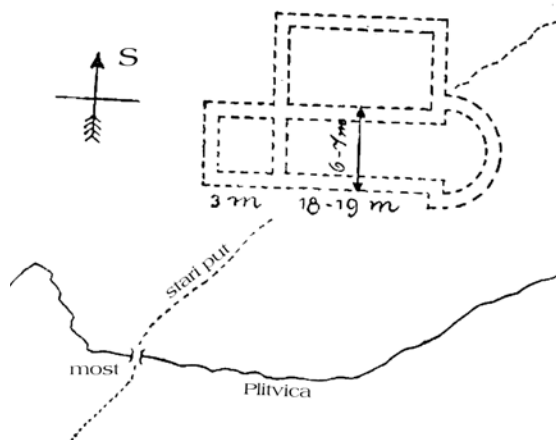

Sl. / Fig. 1: Tlocrt crkve / Plan of the church (Delić 1899, 110; obradio / processed by Srećko Škrinjarić)

were excavated, dated to the 13th–14th centuries.¹⁰ No other excavations apart from this one were carried out within the Park.

The Museum team examined the registered sites from the spatial plan and, in addition to those, discovered several new ones.

The state of knowledge about St. Mark's church

During work on the project *Research, Presentation and Tourist Evaluation of the Archaeological Heritage of the Plitvice Lakes National Park 2011–2013* a significant amount of time was dedicated to the excavation of the church of St. Mark in Široka luka near Rodić Poljana, which belongs to the Plitvica Selo village.

The church was first mentioned on the map entitled *Karlovac in the Period between 1774 and 1775* that was made by the Habsburg Monarchy as part of the first topographic and military survey.¹¹ It was marked as the "Alte Kirch". On the 1780 Jeney-Božić map, it was marked near the source of the Plitvica brook as the "alte Kirche".¹² A school supervisor from Karlovac, Franjo Julije Fras, wrote in 1835 that there still existed visible remains of a former Greek temple near the Pli-

¹¹ Dostupno na: <http://mapire.eu/en/map/fms-karlovac/?zooom=15&lat=44.9069&lon=15.57579> (15.2.2015.)

¹² Franić 1910, 311.

¹³ Fras 1835, 67.

¹⁴ Delić 1899, 94.

¹⁵ Delić piše Luka velikim slovom, što upućuje na ime, a ne na lokaciju (Delić 1899, 109).

¹⁰ Pleše 2010, 2011.

¹¹ Available at: <http://mapire.eu/en/map/fms-karlovac/?zooom=15&lat=44.9069&lon=15.57579> (15. 2. 2015.)

¹² Franić 1910, 311.

sna svećenička odjeća] i crkvene stvari, pa i nešto novaca, sakrili u nju.«¹⁶ Osim tlocrta crkve postavljenog u odnos prema potoku Plitvica, Kamenko Delić daje i geografsku kartu s oznakom položaja crkve, kao i pećine (karta 1).

Muzejski povjerenik, Cvjetko Vurster, 1902. g. piše da se »u selu govori da kod vrela potoka Plitvice izoravaju ploče i hrbine, da ima ostanaka stare crkve, da se tu nalazi velika neistražena špijla puna kojekakvih kostiju«.¹⁷ Kako navodi Vurster, tih godina cijela Široka luka je prekopana u potrazi za »blagom«.

Profesor Dragutin Franić 1910. za crkvu piše: »Vele, da je pred 100 godina bio još cio »toranj« (zvonik) crkve sv. Marka, na koji se bila smreka naslonila, ali zvona nije bilo, jer su zvona iz nje prodali u Drežniku. Sedru od te crkve bacali su mnogo u duboki vir spram crkvine. Na crkvi je bilo i napisa (glagoljskih), ali ih pastiri izodbijali.« Dalje piše da je na sv. Marka (po Jurjevu) u mjesecu travnju bila velika suša te da je trebalo moliti za kišu. Tako su se 1880. g. dogovorili da povedu procesiju za kišu kod crkve sv. Marka na Plitvici. Za tu priliku sagradili su oltar »na istom mjestu gdje je, Bog zna koga stoljeća, pop glagoljaš Bogu žrtvu prinosisio.«

Dalje piše da je blizu razvaline stare crkve pećina, u kojoj je pred 50 godina neki Stojan Grbić našao zvona, »odeždu« (misnu svećeničku odjeću) i sve što svećeniku treba za službu božju. To je on sve odnio u Drežnik i prodao.¹⁸

I konzervator, Zorislav Horvat, 2003. spominje ovu crkvu, te je smješta u doba mađarsko-hrvatskih kraljeva i romanike s kraja 12. st. Napominje da su nam romanički objekti Krbavsko-modruške biskupije većinom poznati po svojim tlocrtima, ne i po elevacijama i detaljima ili sigurnim povijesnim podacima. U isti vremenski period smješta i pretpostavljenu crkvu i pavlinski samostan na gradini Krčingrad nad Gradinskim jezerom na Plitvičkim jezerima, čiji je tipični romanički tlocrt nastao tijekom 12.–13. st., nakon 1185. g. kad je osnovana Krbavska biskupija. Uz tlocrte drugih crkava, daje i mogući tlocrt crkve sv. Marka, s tim da je kod završetka apside stavio upitnik (sl. 2).¹⁹

tvica brook.¹³ Kamenko Delić, the author of the book "Plitvice Lakes and Their Environment" in 1899 wrote that the foundations of a church were located near the source of the Plitvica brook, below the houses of the Rodić family, and that there was also a cave nearby.¹⁴ Kamenko Delić further writes that the residents of Plitvica Selo, whose surname was Grbić, said that there had indeed been a "Greek church" there, because this entire area, in the words of their forefathers, had been a "Greek" land. They call this church *Crkvina Luke*¹⁵ near Plitvica. The book features a (very unusual) layout of the church, with indicated dimensions (Fig. 1). "I found out that the church was positioned as follows. The southern foundation is clearly discernible; its length is between 18–19 m. The eastern part is rounded and well-preserved; here was the altar, and it was 6–7 m wide. The north-eastern foundation cannot be seen due to all the stones that are heaped there; but I think that it ran parallel with the south-eastern end. Here one can also see, although it is hard to tell, that there was another wall there, possibly rooms or cells for priests. The western end is not discernible, although it seems that a tower may have stood there. ...In the vicinity, one can find dressed travertine stone, and this same stone is found also in the foundations... Right here next to *Crkvina*, a bridge over the Plitvica brook has been built, and there is an old path leading towards *Prijeka Kosa* and further to *Babin Potok*. When this land was cleared, people found knives, sabres and various ironware along this path ...", "Around the church, people had also encountered Greek inscriptions on stone, but all of this has perished. Next to *Crkvina*, to the east, there was a place where coins were buried, however, some Greeks took these coins away. South-east of *Crkvina* there was a cave, but now it has been almost entirely filled. About this cave, one man named *Dane* relates that he heard his late grandfather *Aleksa* say that, when the Greeks fled this land, they hid the mass vestments and church objects, as well as some money, inside the cave."¹⁶ In addition to the ground plan of the church, positioned relative to the Plitvica brook, Kamenko Delić

¹⁶ Delić 1899, 109–110.

¹⁷ Arhiv AMZ, 06.02.1902.

¹⁸ Franić 1910, 311–312.

¹⁹ Horvat 2003, 22–24.

¹³ Fras 1835, 67.

¹⁴ Delić 1899, 94.

¹⁵ Delić wrote *Luka* with a capital letter, which points to a name, not a location (Delić 1899, 109).

¹⁶ Delić 1899, 109–110.

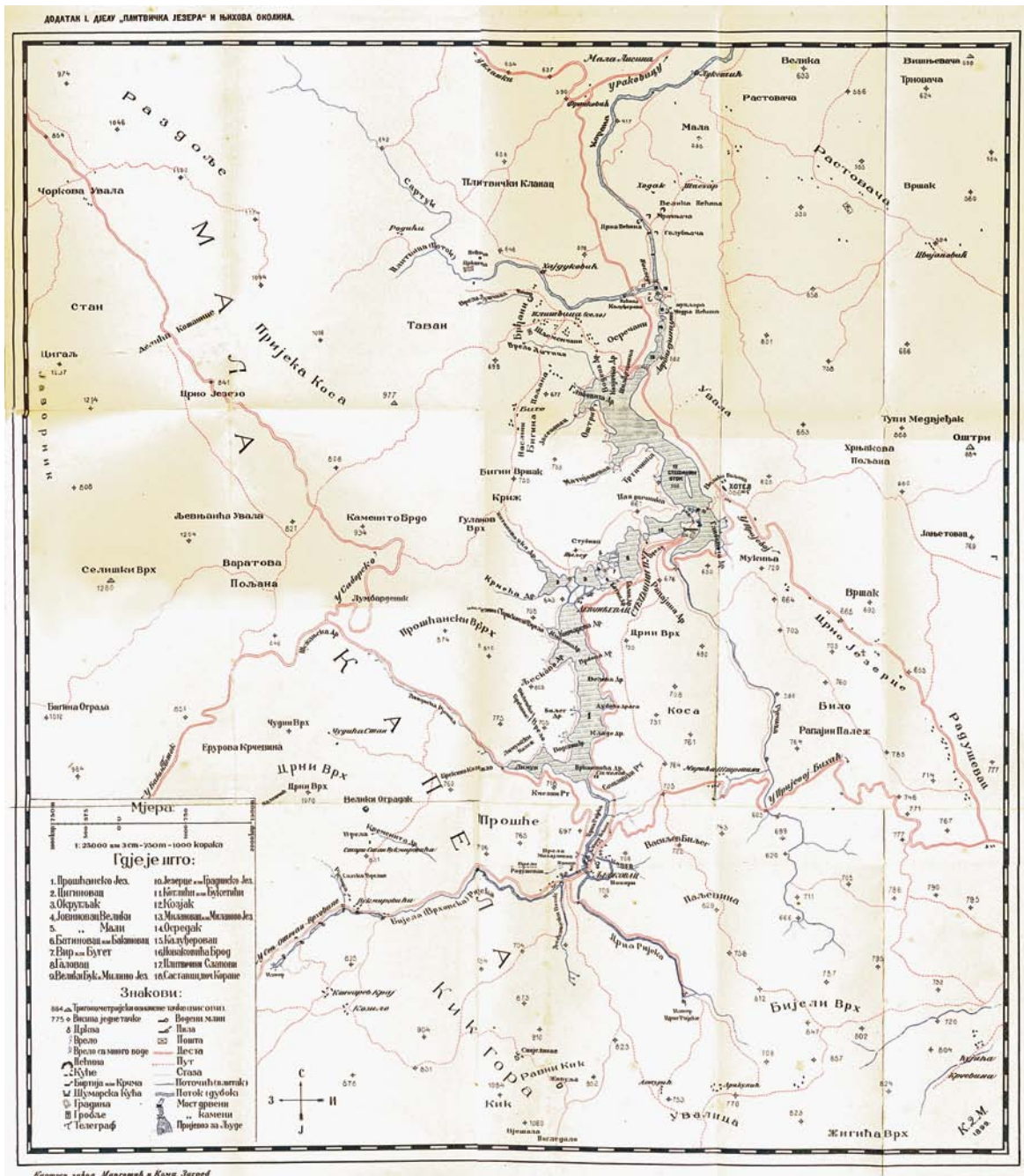

Karta / Map 1: Nacionalni park Plitvička jezera (Delić 1899, 184). Na karti je označen položaj crkve i jame-pećine / Plitvice Lakes National Park (Delić 1899, 184). The position of the church and the pit-cave is marked on the map (obradio / processed by Srećko Škrinjarčić).

Opis lokacije

Potok Plitvica dužine 4 km dio je Plitvičkog sustava, a njegove vode tvore najveći Plitvički slap visine 76 m, što se iznad Sastavaka na kraju jezera Novakovića brod ruši u kameno udubljenje tvoreći početak rijeke Korane. Potok Plitvica izvire kao jako krško vrelo ispod strmih stijena na visi-

also provided a geographical map with the marked position of the church and the cave (map 1).

Cvjetko Vurster, a Museum commissioner, wrote in 1902 that “it is said in the village that people were ploughing out slabs and shards near the source of the Plitvica brook, that there exist the remains of an old church, and that there is a large unexplored

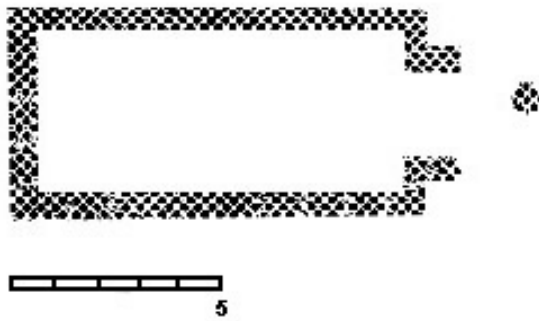

Sl. / Fig. 2: Tlocrt crkve sv. Marka / Plan of St. Mark's church (Horvat 2003, 24; obradio / processed by Srećko Škrinjarić)

ni od 606 m.n.v. Oko 800 m nizvodno od izvora, ispod zaselka Rodić Poljana (u Karabajinoj luci) u Plitvicu se ulijeva potok Sartuk (sl. 3). Od izvora do utoka potoka Sartuk, otprilike u dužini od 800 m, Plitvica je usječena u klanac. Prvo proširenje s kućama i oranicom nalazi se kod utoka potoka Sartuk u Plitvicu, tzv. Karabajine luke, a u produžetku je drugo proširenje, Široka luka, na geografskoj karti označenoj kao Prkežinka. Na Karabajinoj luci nalaze se danas porušene kuće obitelji prezimena Rodić (nadimka Karabajaja) (sl. 4). Prema pričanju lokalnih žitelja, Karabajina luka rijetko kad je plavna. Na istočnoj strani Karabajine luke, kroz uski prolaz između potoka Plitvica i početka uzbrdice, ulazi se u Široku luku kojoj su vlasnici Rodići i Sertići. Široka luka često je poplavljena, u jesen i proljeće, te zbog toga u njoj nema kuća. Prema pričanju Anke Rodić, vlasnice zemljišta, na njihovoj njivi nalazila se hrpa kamenja i sedre, što je njezin muž upotrijebio za gradnju zidića (lokalni naziv – bajer) uz potok Plitvicu, ne bi li na taj način smanjio poplave (sl. 5). Kamenje i sedra koje su uzimali, nalazili su se na nešto povišenom dijelu Široke luke, odnosno na početku uzbrdice. To je lokacija ruševine crkve sv. Marka koja je danas prekrivena zemljom. Gospođa Anka Rodić zna da je tu nekada, prema predaji, bila crkva, no ona tvrdi da nikada nije vidjela njezine ostatke (sl. 6). Prilikom oranja našli su desetak potkova, kao i željeznih čavala, koje nisu sačuvali. Cijelu livadu i povišeni dio iznad livade čistili su od kamenja radi lakšeg oranja. Gospođa Rodić kaže da je cijelo brdo iznad livade nekad bilo pašnjak. Danas je to gusta šuma. Na otprilike polovici brda nalazi se i ruševni pastirski stan obitelji Sertić, koji je danas u dubokoj šumi,

cave full of all kinds of bones there".¹⁷ In Vurster's words, all of Široka luka was dug through and through in search of *treasure* during those years.

In 1910, prof. Dragutin Franić wrote the following about the church: "They say that the (bell) "tower" of St. Mark's church was still standing 100 years ago. A spruce leaned against the tower, but the bells were missing, because they had been sold in Drežnik. A lot of travertine stones from the church were thrown into the deep whirlpool opposite the church. There were a number of glagolitic inscriptions on the church, but the shepherds chiselled them away". He further writes that, on St. Mark's day (after St. George's day) in April, there had been a big drought and people needed to pray for rain. Thus in 1880 they agreed to organise a procession for rain at the church of St. Mark in Plitvica. For that occasion, they built an altar "at the same place where, God knows in which century, a glagolitic priest made a sacrifice".

He then mentions a cave near the ruins of the old church in which, 50 years ago, one Stojan Grbić had found bells, a mass vestment and everything a priest needs for the holy service. This he took to Drežnik and sold it there.¹⁸

This church is mentioned also by the conservator Zvonimir Horvat in 2003, who dated it to the time of the Hungarian-Croatian kings and the Romanesque period at the end of the 12th century. He stated that the Romanesque buildings of the Krbava-Modruš Diocese are known to us mainly by their ground plans, not by the elevations and details or credible historical data. He also dated the presumed church and the Pauline monastery on the Krčingrad hill above the Gradina Lake in the Plitvice Lakes to the same period, whose typical Romanesque plan was formed during the 12th–13th century, after the foundation of the Krbava Diocese in 1185. In addition to the plans of other churches, he offered also a possible plan of St. Mark's church, beside whose apse he placed a question mark (Fig. 2).¹⁹

Description of the location

¹⁷ Archives of the AMZ, 6th February 1902.

¹⁸ Franić 1910, 311–312.

¹⁹ Horvat 2003, 22–24.

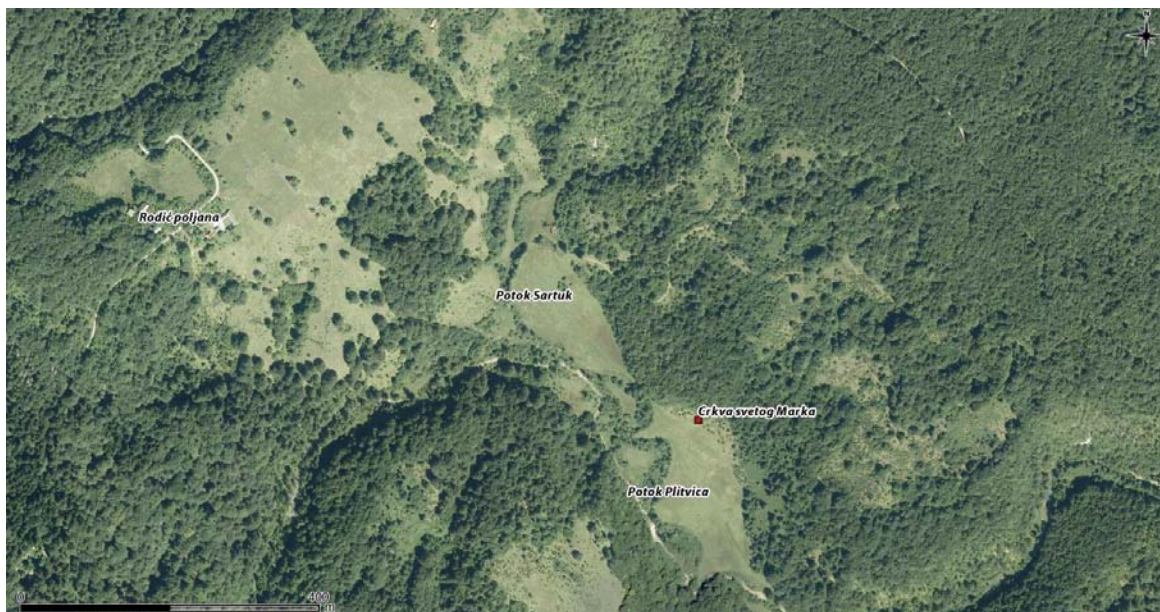

Sl. / Fig. 3: Označeni položaji Rodić poljana, potoka Sartuk na Luci (Karabaja) i potoka Plitvica u odnosu na crkvu sv. Marka (Široka luka) / Marked positions of Rodić poljana, the Sartuk brook at Luka (Karabaja) and the Plitvica brook relative to St. Mark's church (Široka luka) (© Google maps, obradila / processed by Nera Šegvić)



Sl. / Fig. 4: Karabajina luka, razrušena kuća Rodić (Karabaja). Iza kuće na brdu smještena je Rodić poljana / Karabajina luka, the ruined house of the Rodić family (Karabaja). Rodić poljana is located behind the house on the hill (snimila / photo by Iva Kostešić, 2011.)



Sl. / Fig. 5: Kamenom ograden potok Plitvica u Širokoj luci / Stone-lined Plitvica brook in Širokoj luci (snimila / photo by Iva Kostešić, 2012.)

a prema riječima jedne od vlasnica, Marice Sertić, stan je bio u funkciji do 1990 g., kad je napušten uslijed ratnih zbivanja (Domovinski rat). Stan se sam od sebe urušio tijekom vremena. Zanimljivo je da nitko od njih (Rodići, Sertići, rendžeri Parka, mještani...) nije znao niti čuo za pećinu u kojoj su, prema predaji, bile sakrivene »crkvene stvari i nešto novaca«.

Od mještana smo saznali za tri moguće lokacije crkve. Pregledom terena ustanovili smo da su dva

The 4-km long Plitvica brook is a part of the Plitvice Lakes system. Its waters form the biggest waterfall in the Lakes, 76 m high, falling into a rocky depression above the Sastavci at the end of the Novakovića brod Lake, thus forming the beginning of the Korana river. The Plitvica brook springs out as a powerful karst source below the steep cliffs at the altitude of 606 m.a.s.l. Around 800 m downstream, below the Rodić Poljana hamlet (in Karabajina luka), the Sartuk brook

položaja na samim rubovima Široke luke, istočnom i zapadnom, gdje je potok Plitvica vrlo blizu početku uzbrdice. Na uskom prolazu između Karabajine i Široke luke, u neposrednoj blizini suhog korita potoka Plitvice, na nešto povišenom terenu postavili smo sondu 4 dimenzija – 1,5 x 1,5 m. Ustanovljeno je da je riječ o seoskom puteljku, koji vodi prema istoku, a trag mu se gubi već nakon 30-ak metara. Lokacija puta označena je kamenim stupićem (lokalni naziv – unka), na kojoj je crvenom bojom napisan broj 245, te strelica prema istoku. Na samom putu na bočnom kamenu gdje je put usječen u padinu, 2–3 m udaljen od kamenog stupića, sa sjeverne strane napisan je crvenom bojom troznamenasti broj, od kojih su prve dvije znamenke 22, a treća znamenka je slabo vidljiva.

Na istočnom završetku Široke luke, kod početka staze koja vodi prema Hajdukovića pili, u neposrednoj blizini potoka Plitvica, na nešto povišenom terenu, u gustom žbunju pronađena je hrpa kamenja, te još jedan kameni stupić – unka, bez oznaka (sl. 7). Kako je današnji put prema Hajdukovića pili, u pravcu Velikog slapa, jedini mogući put, pretpostavka je da je stari put išao po istoj trasi, a bio je obilježen stupićima.

Arheološka istraživanja crkve sv. Marka

Na povišenom terenu Široke luke započeli smo iskopavanja crkve sv. Marka (sl. 8).



Sl. / Fig. 6: Gospođa Anka Rodić i njezin unuk stoje na položaju crkve sv. Marka. Na uzvisini bijeli se krov njezine kuće na Rodić poljani / Mrs Anka Rodić (and her grandson) standing at the position of St. Mark's church. The white roof of her house can be seen on the elevated position at Rodić poljana (snimila / photo by Iva Kostešić, 2011.)

flows into the Plitvica brook (Fig. 3). From the source to the mouth of the Sartuk brook, the Plitvica flows through a canyon. The first open area with houses and a field, the so-called Karabajina luka, is found at the mouth of the Sartuk brook, from which extends another field, Široka luka, marked on the geographic map as Prkežinka. Located in Karabajina luka are the now-decrepit houses of the Rodić family (nicknamed Karabajina) (Fig. 4). In the words of local residents, Karabajina luka is seldom flooded. In the eastern side of Karabajina luka, through a narrow passage between the Plitvica brook and the beginning of the slope, one enters Široka luka, owned by the Rodić and Sertić families. Široka luka is often flooded in autumn and spring, due to which there are no houses there. In the words of Anka Rodić, the owner of the land, there were piles of stone and travertine on their field, which her husband used to build a small wall (which the locals call a *bajer*) along the Plitvica brook, in order to reduce flooding (Fig. 5). Stones and travertine that he took lay on a slightly raised part of Široka luka, that is, at the beginning of the upward slope. This is the position of the ruins of the church of St. Mark, which is now covered with earth. Mrs Anka Rodić is aware of the tradition that says that a church once stood there, but she claims never to have seen its remains (Fig. 6). They ploughed out a dozen horseshoes, as well as iron nails, which they did not keep. They cleared the



Sl. / Fig. 7: Cestovna oznaka – kameni stup na istočnom ulazu u Široku luku / Road mark – stone pillar at the eastern entrance to Široka luka (snimila / photo by Nera Šegvić, 2012.)



Sl. / Fig. 8: Pogled na lokaciju crkve sv. Marka u Širokoj luci, prije iskopavanja / A view of the position of St. Mark's church in Široka luka prior to the excavation (snimila / photo by Nera Šegvić, 2011.)

Sonda 1 nije odmah dala rezultat (naknadno smo ustanovili da je postavljena u unutrašnjosti crkve), te smo otvorili sondu 2, dimenzija 2 x 2 m, koju smo proširivali. Ukupna površina sonde 2 je 28 m², u njoj su otkriveni dijelovi zapadnog i južnog temelja zida crkve, te tri groba. Jedan grob (grob 3) nalazio se unutar zidova crkve, uz južni zid, a dva paralelno s južnim zidom s vanjske strane crkve (grob 1 i 2) (T. 1).

Zbog nedostatka vremena daljnja iskopavanja svela su se na otkopavanje zida, da bismo dobili tlocrt crkve, a zaobišli (eventualne) grobove. Osim manjeg dijela jugozapadnog kraja unutrašnjost crkve nije istražena. Pratili smo zid crkve u širini od 0,30 m sa svake strane (širina lopate). Uz manja preskakanja otkopavanja temelja (sonda 2, 5, 6), dobiveni tlocrt crkve je sljedeći: orijentacija je istok – zapad s odklonom 24° prema jugoistoku. Četvrtasta apsida, uža od broda crkve, nalazi se na istoku. Duljina apside 4,31 m, širina apside 5,32 m, duljina broda 15 m, širina broda nije ustanovljena. Ako se pretpostavi da je crkva imala pravilan tlocrt, širina broda iznosila bi 7,85 m (T. 2 i T. 3).

Temelj zida cijelog otkopanog dijela crkve je širine 0,75–0,90 m, visine 0,30 m. Površina otkopanog temelja zida prilično je ravna i bez utora. Temelj crkve rađen je od priklesanog kamenja povezanoga žbukom. Zapadni zid crkve, gdje je, pretpostavljamo, bio ulaz, polukružno se urušio. Urušenje je od neobrađenog i poluobrađenog kamenja, a u njemu se nalazi i nešto sedrenih gru-

stones from the entire meadow and the elevated part above it to facilitate ploughing. Mrs Rodić says that the entire hill above the meadow was once pasture land, but today it is covered with dense forest. Approximately at the mid-height of the hill stands the decaying shepherd dwelling of the Sertić family, which is now deep in a forest, although, in the words of one of the owners, Marica Sertić, it was in use until 1990, when it was abandoned due to the war (Croatian War of Independence). Over time, the dwelling collapsed into itself. Interestingly, none of them (the Rodić and Sertić families, Park rangers, local residents...) had ever heard anything or had any knowledge about the cave in which, according to the tradition, “church objects and some money” were hidden.

Local residents told us about three possible locations for the church. Our reconnaissance survey documented two positions at the very edges of Široka luka, the eastern and western, where the Plitvica brook comes very near to the beginning of the upward slope. In the narrow passage between Karabajina luka and Široka luka, adjacent to the dry bed of the Plitvica brook, on a slightly elevated terrain, we excavated Sonda 4, the dimensions of which are 1.5 x 1.5 m. The excavation uncovered an eastbound village path whose trace is lost after 30 or so metres. The location of the path is marked with an upright stone (which the locals call *unka*), on which the number 245 is written in red, accompanied by an arrow pointing east. On a lateral stone on the path, where it cuts into the slope, 2–3 metres from the stone pillar, written in red is a three-digit number whose first two digits are 22, while the third one is poorly visible.

At the eastern end of Široka luka, near the beginning of the path leading to Hajdukovića pila, adjacent to the Plitvica brook, a pile of stones was found in a dense thicket on slightly elevated terrain, together with another stone pillar (*unka*), this one without any marks (Fig. 7). Since the present-day path towards Hajdukovića pila, in the direction of the Big Waterfall, is the only possible path, the old path presumably led along the same route, and it was marked with stone pillars.

mena. Budući da je sedra građevni materijal koji je lak za obrađivanje i koji je u prvom redu lagan, vrlo je vjerojatno da je njime crkva bila presvođena. Ujedno je to jedino kamenje koje je nađeno u okolini iskopanog dijela temelja. Površinsko kamenje, kako je već rečeno, razneseno je radi obrade zemljišta. Sjeverni temelj apside nakon manje od 2 m naglo prestaje, vidljivo je da je kamen izvađen i odnesen. Sonda 7 imala je za cilj naći nastavak sjevernog zida, te je ustanovljeno da zid nedostaje.

Sonda 3 imala je za cilj provjeriti Delićev crtež pomoćne prostorije na sjevernoj strani crkve. Osim kamenja odmah ispod površinskog sloja, na zapadnom dijelu sonde, uočen je nešto pravilnije slagani kamen, za koji nije ustanovljeno je li dio zida, ili je kamen tako složen uslijed oranja. Na žalost, nije bilo više vremena za proširenje sonde.

Grobovi

U sondi 2 otkriveni su dijelovi zapadnog i južnog zida i ugao, te su pronađena i tri groba (sl. 9).

Grob 1 (dijete?) nalazio se s vanjske strane južnog zida. Kostur očuvan, položen na leđa s glavom na zapadu. Noge su ispružene, potkoljenice nedostaju. Ruke – desna podlaktica podignuta na sredinu toraksa, a lijeva položena na trbuh (sl. 10).

Grob 2 (žena?) nalazio se s vanjske strane južnog zida. Kostur dobro očuvan, s glavom na zapadu.



Sl. / Fig. 9: Kameno urušenje zapadnog zida, s vidljivim ostacima tri istražena groba / Stone debris of the western wall with visible remains of three excavated graves (snimila / photo by Nera Šegvić, 2012.)

Archaeological excavation of St. Mark's church

We started excavating the church of St. Mark at the elevated ground of Široka luka (Fig. 8).

Since Sondage 1 did not immediately yield anything (we later discovered that it was positioned in the interior of the church), we started excavating in Sondage 2, measuring 2 x 2 m, which we later enlarged. The total area of Sondage 2 is 28 m², and it yielded parts of the western and southern foundation walls of the church, as well as three graves. One of the graves (grave 3) lay inside the church walls, next to the southern wall, while the other two lay parallel to the southern wall on the outside of the church (graves 1 and 2) (Pl. 1).

Due to lack of time, the excavation was limited to the uncovering of the wall, with the aim of revealing the plan of the church while bypassing (potential) graves. Apart from a minor part of the south-western end, the church interior was not investigated. We followed the wall of the church in the width of 0.30 m at either side (the width of a shovel). With minor omissions in the excavation of the foundations (Sondages 2, 5, 6), we obtained the following plan: the church is oriented east-west with a 24° tilt towards south-east. The rectangular apse, narrower than the church aisle, is located in the east. The apse is 4.31 m long by 5.32 m wide, the aisle is 15 m long, but its width has not been ascertained. If we assume that the church had a regular plan, it would have been 7.85 m wide (Pl. 2 and Pl. 3).



Sl. / Fig. 10: Grob 1, nađen s vanjske strane južnog zida crkve / Grave 1 was discovered outside the southern wall of the church (snimila / photo by Iva Kostešić, 2012.)



Sl. / Fig. 11: Grob 2, nađen s vanjske strane južnog zida crkve / Grave 2 was discovered on the outside of the southern church wall (snimila / photo by Iva Kostešić, 2012.)



Sl. / Fig. 12: Grob 3, nađen u unutrašnjosti crkve / Grave 3 was found inside the church (snimila / photo by Iva Kostešić, 2012.)

Pokojnica je položena na lijevi bok, lijeva noga je ispružena, a desna zgrčena. Pokojnica ima desnu podlakticu položenu na trbuhu (sl. 11).

Grob 3 (muškarac?) nalazio se unutar crkve, uz južni zid. Kostur dobro očuvan, položen na leđa paralelno uz zid, s glavom na zapadu. Noge su ispružene, a ruke položene kao i u grobu 1. (sl. 12).

Svi grobovi su bez priloga i bez nalaza.

Naziv crkve

Kamenko Delić 1899. crkvu naziva *Crkvina Luke kod Plitvice*, dok Dragutin Franić 1910. crkvu naziva sv. Marko, prema evanđelistu. Najčešći izraz je »Crkvina«, ili »Crkvište«, bez oznake sveca kojem je posvećena. Cvjetko Vurster 1902. g. spominje staru crkvu, ali bez naziva. Na povijesnim kartama crkva je obilježena kao »alte Kirche«, također bez naziva.

Kako je povijesno sjećanje izbrisano u tom kraju, čini se da su doseljenici krajem 17. st. i početkom 18. st. dali Crkvini vlastite nazive, ali da nisu obnavljali samu crkvu. Titular sv. Marko podsjeća na nekadašnje trgovačke veze s Mletačkom Republikom, ili kako je uz druge i Gušić zove, Republikom sv. Marka iz vremena prije Turaka.²⁰

²⁰ Gušić 1974, 72.

The foundation of the wall of the entire excavated part of the church is 0.75–0.90 m wide and 0.30 m high. The surface of the excavated foundation wall is fairly flat, without grooves. The church foundations were built of roughly dressed stones bound with mortar. The western wall of the church, where the entrance was probably located, collapsed in a semi-circular manner. The debris consists of undressed and semi-dressed stones, as well as a few lumps of travertine. Since travertine is easily worked and above all light, it was probably used as a building material for the church vault. This is also the only type of stone found around the excavated portion of the foundation wall. Surface stones, as already stated, were removed to clear the land for cultivation. The northern foundation wall of the apse abruptly stops after less than 2 m, clearly because the stones were taken away. The purpose of Sondage 7 was to find the continuation of the northern wall, and it was revealed that it was missing.

Sondage 3 was excavated to verify Delić's drawing of the accessory room at the northern side of the church. In addition to the stones lying immediately below the topsoil, the excavation in the western portion of the sondage uncovered a rather regular course of stones, although it is unclear whether they belonged to a wall, or if the stones were set in this manner because of farming. Unfortunately, there was not enough time to expand the sondage.

Jama – pećina

Cvjetko Vurster piše da se u okolici crkve nalazi i pećina *puna kojekakvih kostiju*.²¹ Položaj pećine ucrtan je na karti koju daje Kamenko Delić 1899. g. Nalazi se na sjevernoj strani zašumljenog starog puteljka, koji vodi do (danas) ruševnog pastirskog stana Sertić (sl. 13). Puteljak nema početak ni kraj jer je cijeli taj dio zarastao u šumu i paprat. Puteljak je mjestimično podzidan, a s južne strane nalazi se veliko, neobrađeno kamenje. Moguće je da je početak puteljka kod ulaza u Široku luku, gdje je pronađen stupić s brojčanom oznakom. Zapadno od pastirskog stana, uz navedeni put, nalazi se veća jama. Njene su dimenzije 3,60 cm x 4,70 cm, a dubina joj je 2,80 m. Stranice jame čini živa stijena četverokutnog oblika, prilično zaglađenog lica. Dno jame je zatrpano debelim slojem lišća i trulog granja (sl. 14). Pristupili smo čišćenju jame od trulog lišća i granja, te ustanovili da je ispod nataloženog sloja jama zapunjena većim komadima kamenja koje nismo mogli dizati bez dodatne opreme. Uz istočne stijenke jame, na dubini od 3 m, otkrivena je manja rupa, odnosno prolaz, kroz koju bi se (teško) mogao provući čovjek (sl. 15). Dizanjem većeg kamenja kojim je jama zapunjena, taj bi se otvor mogao proširiti. Pretpostavka je da je kroz tu rupu prolaz prema pećinskom dijelu tog objekta (ukoliko pećinski dio postoji). S obzirom na to da prilikom čišćenja jame nismo naišli na nikakve tragove ljudske intervencije, završili smo s istraživanjem. Eventualnim dizanjem sloja većih kamenih blokova možda bi se moglo naići na tragove ljudske prošlosti.

Ni lokalno stanovništvo ni vlasnici zemljišta nisu znali za jamu, te su je prvi puta vidjeli kada smo im je pokazali. Nisu znali ni za predaje vezane uz pećinu. Prema literaturi,²² zvona crkve sv. Marka su bila sakrivena u jami-pećini, te kad su nađena, prodana su u Drežniku. U vrijeme pisanja knjiga Delića i Franića, te izvještaja muzejskog povjerenika Cvjetka Vurster, ²³ jama je već bila zatrpana kamenjem, te se izvještaj zapravo odnosi na usmenu predaju.

Jamu bi trebalo očistiti od kamenja, te istražiti.

²¹ Arhiv AMZ, 06.02.1902.

²² Delić 1899, 94; Franić 1910, 311–312.

²³ Arhiv AMZ, 1902.

Graves

Sondage 2 yielded the remains of the corner portion of the western and southern walls, as well as three graves (Fig. 9).

Grave 1 (child?) was located on the outside of the southern wall. The skeleton is preserved and was found in a supine position with its head towards the west. The legs are extended, and the lower legs are missing. Arms – the right forearm is placed at the middle of the thorax, the left forearm is placed on the abdomen (Fig. 10)

Grave 2 (woman?) lay on the outside of the southern wall. The skeleton is well preserved, with its head towards the west. The deceased woman was placed on the left side, with her left leg extended and her right leg flexed. The right forearm is placed on the abdomen (Fig. 11).

Grave 3 (man?) was located inside the church, next to the southern wall. The skeleton is well preserved, in a supine position parallel with the wall, with the head towards the west. The legs are extended and the arms were placed the same as in grave 1 (Fig. 12).

None of the graves contained any goods or other finds.

The name of the church

Kamenko Delić in 1899 called the church *Crkvina Luke near Plitvica*, while Dragutin Franić in 1910 referred to it as St. Mark's church, after the Evangelist. The most common term is "Crkvina" or "Crkvište", without the name of the patron saint. Cvjetko Vurster mentions an old church in 1902, but did not mention its name. On historical maps, it is marked as the "alte Kirche", likewise without any name.

Since the historical memory in that area was lost, it seems that the new settlers at the end of the 17th century and the beginning of the 18th century gave their own names to *Crkvina*, but did not restore the building itself. The patron, St. Mark, reminds of former commercial ties with the Venetian Republic, or, in the words of Gušić and others, the Republic of St. Mark, from the time before the Turks.²⁰

²⁰ Gušić 1974, 72.



Sl. / Fig. 13: Porušena kuća, »stan« od Sertića, nedaleko od jame – pećine / The collapsed house, "dwelling" of the Sertić family, near the pit-cave (snimila / photo by Iva Kostešić, 2012.)



Sl. / Fig. 14: Spuštanje u jamu-pećinu kod crkve sv. Marka (na slici Bojan Grbić, mještanin) / Descent into the pit-cave near St. Mark's church (Bojan Grbić, a local resident, is pictured in the photo) (snimila / photo by Iva Kostešić, 2012.)



Sl. / Fig. 15: Pokušaj ulaza u uski prolaz koji (moguće) vodi u dubinu pećine (na slici Bojan Grbić, mještanin) / Attempt to pass through the narrow passage that (might) lead into the cave (Bojan Grbić is shown in the photo) (snimila / photo by Nera Šegvić, 2012.)

The pit – cave

Cvjetko Vurster writes that there is a cave in the vicinity of the church, *full of all kinds of bones*.²¹ The position of the cave is marked on the map provided by Kamenko Delić in 1899. It is situated on the northern side of the wooded old trail leading to the (presently) crumbling shepherd dwelling of the Sertić family (Fig. 13). The trail has no beginning or end because the entire land had been covered by forest and ferns. The trail is partly supported by a wall, and on the southern side there are massive undressed stones. It is possible that the trail begins at the entrance to Široka luka, where the numbered stone pillar was found. West of the shepherd dwelling, next to the trail, there is a large pit, measuring 3.60 x 4.70 m, 2.80 m deep. Its walls consist of rectangular bedrock with fairly smooth sides. The bottom of the pit is filled with a thick layer of leaves and rotting branches (Fig. 14). We cleaned the pit of leaves and branches, whereupon we found out that, beneath this layer, the pit was filled with large stones, which we were not able to move without additional equipment. At the depth of 3 metres, along the eastern wall of the pit, we uncovered a small hole, or a passageway, through which a man might be able to pass, although with difficulty (Fig. 15). This opening could be expanded by removing the large stones that fill the pit. In case there is indeed a cave there, it is possible that this passage leads into it. However, considering that, during the clearing of the cave, we did not find any traces of human activity, our exploration stopped there, keeping in mind that traces of human history might perhaps be found if the massive stone blocks were to be removed.

Neither the local population nor the land owners knew anything about the pit, and they first saw it when we showed it to them. They were also unaware of the traditions connected with the cave. According to the literature²², the bells of St. Mark's church were hidden in the pit-cave and, when they were found, they were sold in Drežnik. At the time when Delić and Franić wrote their books and the Museum commissioner Cvjet-

²¹ Archives of the AMZ, 6th February 1902.

²² Delić 1899, 94; Franić 1910, 311–312.

Most

Na Delićevom crtežu prikazan je most preko Plitvice, te on opisuje da je »uz Crkvinu ozidan most preko potoka Plitvice, pa načinjen je stari put na Prijeku Kosu i dalje u Babin Potok. Kad se ovdje krčilo, nalazili su ljudi uz ovaj put noževa, sabalja i različitih gvožđarija...«.²⁴ Obišli smo cijeli tok potoka Plitvice na području Široke luke, te ustanovili da je lijeva, sjeverna strana potoka, ograđena kamenjem, a desna, južna, slabije prohodna te se odmah uz njezin tok nalazi gusto pošumljena brina – padina brijega. Tragove puta, kao ni mosta, nismo našli.

Zaključak

Specifičnost ličkog kraja je gradnja crkvi uz izvore žive vode, obično u podnožju brda, na malo izdignutom terenu. Taj običaj govori o važnosti koja se pridavala vodi, ali i kao jednoj od predispozicija za okupljanje većeg broja ljudi.²⁵ Kako je uobičajeno, crkva je bila smještena izvan naselja.

Crkva sv. Marka je jednobrodna crkva s četvrtastom apsidom – duljina broda iznosi 15 m, (pretpostavljena) širina broda oko 7,5 m, duljina apside 4,31 m, a širina apside 5,32 m.

Naselje kojemu je pripadala crkva bilo je izdvojeno od crkve, a nalazilo se (vjerojatno) na Rodić Poljani. Na Rodić Poljani nalazi se danas samo jedna naseljena kuća, u kojoj živi gđa Anka Rodić, vlasnica zemljišta u Širokoj luci, na kojem je crkva sv. Marka. Međutim, na Rodić Poljani postoje vidljivi ostaci razrušenih kuća, nekad manjeg zaseoka. Cijela Rodić Poljana je umjetno zaravnata uzvisina okružena potocima Plitvica i Sartuk, te je idealna za naseljavanje. Rekognosciranjem poljane u krtičnjacima je nađeno nekoliko ulomaka pretpovijesne keramike. Smatramo da je Rodić Poljana bila naseljena od pretpovijesti, te da je vjerojatno netko iz tog naselja zakopao srednjebrončanodobnu ostavu koja je pronađena u blizini. Od ostave, za koju se ne zna točna lokacija nalazišta, već je poznat samo podatak da je nađena »kod izvora Plitvice«, sačuvan je samo

ko Vurster wrote his report²³, the pit had already been filled with stones, so the report in fact refers to the oral tradition.

The pit should preferably be cleared of stone and explored.

The bridge

Delić's drawing depicts a bridge across the Plitvica brook, accompanied by his description that "right here next to Crkvina, a bridge over the Plitvica brook has been built, and there is also an old path leading toward Prijeka Kosa and further to Babin Potok. When this land was cleared, people found knives, sabres and various ironware along this path ...".²⁴ We explored the entire course of the Plitvica brook in the Široka luka area, and found out that the left, northern bank of the brook was lined with stones, while the right, southern side was less accessible, since the bank lies at the foot of a densely wooded upward slope. We did not find any traces of the path or bridge.

Conclusion

A specific feature of the Lika region is that churches are built near water springs, usually at the foot of a hill, on slightly elevated ground. This custom speaks about the importance that people attached to water, while it also served as one of the predispositions for the gathering of a mass of people.²⁵ As usual, the church was located outside the settlement.

St. Mark's is a single-nave church with a rectangular apse – the nave is 15 m long by (presumably) around 7.5 m wide. The length of the apse is 4.31 m and the width is 5.32 m.

The settlement to which the church belonged was situated at a distance, probably at Rodić Poljana. Today, there is only a single inhabited house at Rodić Poljana, in which lives Anka Rodić, the owner of the land in Široka luka, the site of St. Mark's church. However, there are visible rema-

²⁴ Delić 1899, 110.

²⁵ Horvat 2003, 15.

²³ Archives of the AMZ, 1902.

²⁴ Delić 1899, 110.

²⁵ Horvat 2003, 15.

mač koji je pohranjen u Arheološkom muzeju u Zagrebu.²⁶

Prostor južno od ostataka crkve sv. Marka zauzima groblje. Bilo bi zanimljivo istražiti veličinu i širinu groblja, za koje se do sada nije znalo da postoji. Na tom području nalaze se ulomci keramike (pretpovijesni i kasnosrednjovjekovni) koji su na to područje vjerojatno dospjeli ili poplavom potoka Plitvice, ili s brda iznad crkve.

Cijelu lokaciju (Rodić Poljanu – pretpovijesno i povijesno naselje, crkvu sv. Marka s pripadajućim grobljem u Širokoj luci, Prkežinku) trebalo bi cjelovitije istražiti. Jedino na taj način mogli bismo dobiti egzaktnije podatke o prošlosti toga kraja.

ins of decaying houses at Rodić Poljana, which once belonged to a small hamlet. The entire Rodić Poljana is an artificial flat elevation surrounded by the Plitvica and Sartuk brooks, ideal for settlement. Reconnaissance surveys of the Poljana area yielded several shards of prehistoric pottery from molehills in the field. We believe that Rodić Poljana was inhabited in prehistory and that probably somebody from the prehistoric settlement buried the Middle Bronze Age hoard that was found in the vicinity. We do not know the exact position where the hoard was found, except that it was “at the source of the Plitvica brook”. The only preserved object from the hoard is a sword that is kept in the Archaeological Museum in Zagreb.²⁶

The area south of the remains of St. Mark’s church is occupied by a graveyard. It would be interesting to explore the length and width of the graveyard, which we previously did not know existed. The potshards found in this area (prehistoric and mediaeval) probably arrived there either by the flooding of the Plitvica brook, or from the hill above the church.

The entire zone (Rodić Poljana with its prehistoric and historical settlements, St. Mark’s church with its adjoining graveyard in Široka luka, Prkežinka) ought to be more thoroughly researched, because this is the only way to obtain more precise data about the history of that area.

²⁶ Drechsler-Bižić 1983, 243, 252.

²⁶ Drechsler-Bižić 1983, 243, 252.

Bibliografija / Bibliography

ARHIV AMZ

Brunšmid 1901 – J. Brunšmid, »Hrvatske razvaline«, *Vjesnik Hrvatskoga arheološkoga društva*, Zagreb, n. s., V, 1901, 44–52.

Čulinović-Konstantinović 1974 – V. Čulinović-Konstantinović, »Život i običaji stanovnika Plitvica«, u Gušić, B., Marković, M. (ur.), *Plitvička jezera: čovjek i priroda*, Zagreb, Nacionalni park Plitvička jezera, 1974, 175–190.

Delić 1899 – K. D. M. [Kamenko Delić Mihajlov], *Plitvička jezera i njihova okolina*, Zagreb, Srpska štamparija, 1899.

Drechsler-Bižić 1983 – R. Drechsler Bižić, »Srednje brončano doba u Lici i Bosni«, u Benac, A. (ur.), *Praistorija jugoslavenskih zemalja. IV. Bronzano doba*, Sarajevo, Svjetlost, Akademija nauka i umjetnosti Bosne i Hercegovine, 1983, 242–270.

Franić 1910 – D. Franić, *Plitvička jezera i njihova okolica*, Zagreb, vlast. nakl., 1910.

Gušić 1974 – B. Gušić, »Čovjek i zaštita Plitvičkih jezera«, u Gušić, B., Marković, M. (ur.), *Plitvička jezera: čovjek i priroda*, Zagreb, Nacionalni park Plitvička jezera, 1974, 71–84.

Horbec 2008 – I. Horbec, »Povijesno nasljeđe Nacionalnog parka Plitvička jezera«, u *Konzervatorska studija sa sustavom zaštite i revitalizacije kulturne baštine*, Zagreb, Ministarstvo kulture – Uprava za zaštitu kulturne baštine, Konzervatorski odjel u Zagrebu, 2008.

Horvat 2003 – Z. Horvat, *Srednjovjekovne katedralne crkve Krbavsko-modruške biskupije*, Biblioteka Hrvatska povjesnica. Posebna izdanja, Zagreb, Gospić, Hrvatski institut za povijest, Državni arhiv u Gospiću, 2003.

Kolak, Šušnjić 2008 – T. Kolak i D. Šušnjić, »Problemi istraživanja i zaštite arheoloških lokaliteta na području Like«, u Kolak, T. (ur.), *Arheološka istraživanja u Lici i Arheologija pećina i krša: znanstveni skup, Gospić, 16.-19. listopada 2007.*, Zagreb, Gospić, Hrvatsko arheološko društvo, Muzej Like Gospić, 2008, 209–219.

Pleše 2010 – T. Pleše, »Krčingradska branič-kula«, *Vjesnik Arheološkog muzeja u Zagrebu*, Zagreb, 3. s., XLIII, 2010, 289–307.

Pleše 2011 – T. Pleše, »Arheološka istraživanja na gradini Kozjak«, u Šutić, B. et al. (ur.), *Znanstveno-stručni skup Nacionalnog parka Plitvička jezera povodom 60 godina od osnivanja i 30 godina od upisa na UNESCO-vu Listu svjetske kulturne i prirodne baštine, Plitvička jezera, 16.-16. listopada 2009.: zbornik radova, Plitvička jezera, Javna ustanova "Nacionalni park Plitvička jezera"*, 2011, 346–354.

Vekić 2011 – A. Vekić, »Arheološka topografija Nacionalnog parka Plitvička jezera«, u Šutić, B. et al. (ur.), *Znanstveno-stručni skup Nacionalnog parka Plitvička jezera povodom 60 godina od osnivanja i 30 godina od upisa na UNESCO-vu Listu svjetske kulturne i prirodne baštine, Plitvička jezera, 16.-16. listopada 2009.: zbornik radova, Plitvička jezera, Javna ustanova "Nacionalni park Plitvička jezera"*, 2011, 329–345.



Tabla / Plate 1: Crkva sv. Marka – učitane su sondage 1, 2, 5, 6, 7 / St. Mark's church – Sondages 1, 2, 5, 6, 7 are marked (crtež / drawing by Nera Šegvić, Paula Androić, Iva Kostešić; priredila za tisak / design by Iva Kostešić, 2014.)



Tabla / Plate 2: Crtež otkopanih dijelova temelja zida crkve sv. Marka / A drawing of the excavated parts of the foundation walls of St. Mark's church (crtež / drawing by Nera Šegvić, Paula Androić, Iva Kostešić; priredila za tisak / design by Iva Kostešić, 2014.)

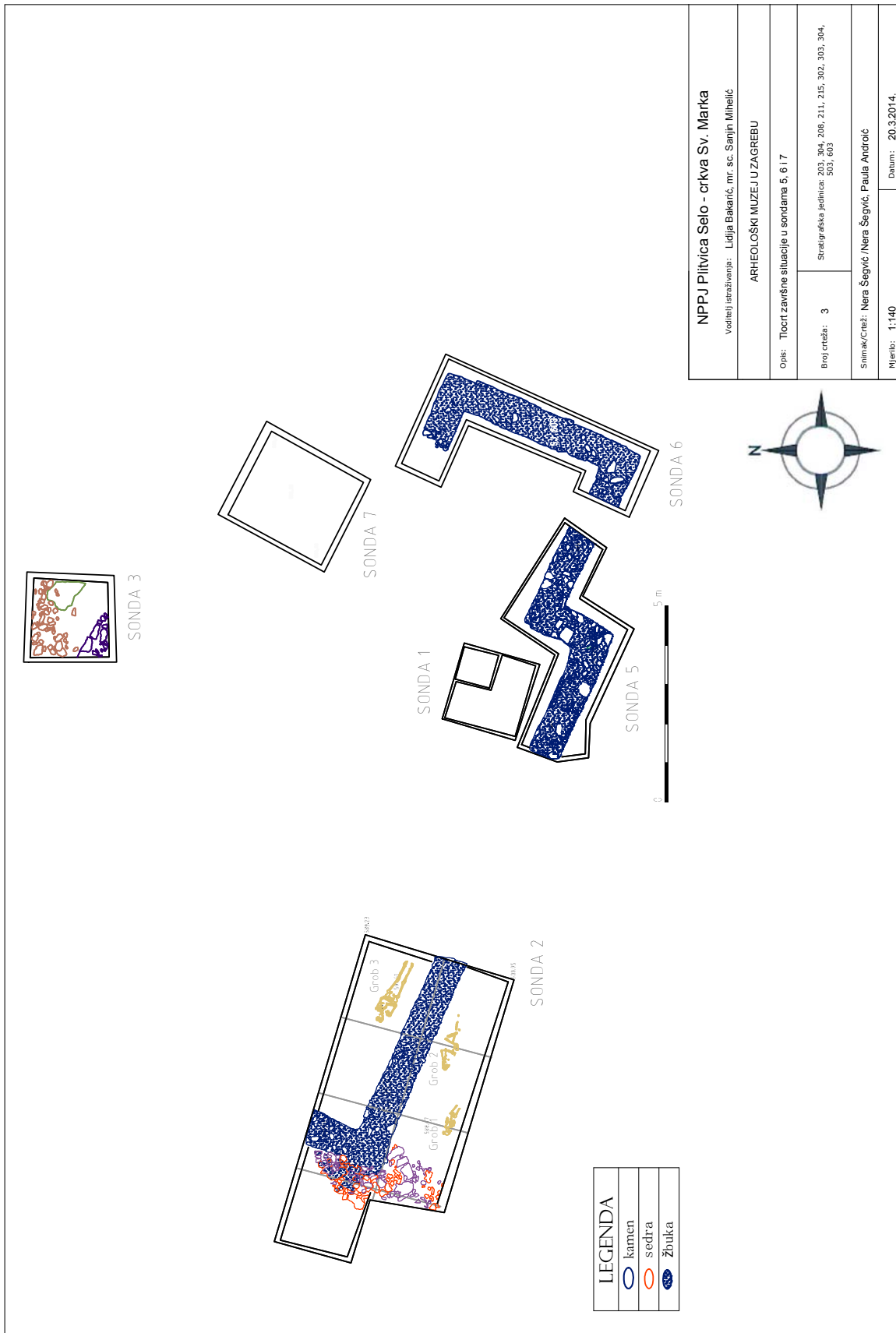

Tabla / Plate 3: Crtež idealne rekonstrukcije crkve sv. Marka. Naznačeni su otkopani dijelovi zida temelja, pretpostavljeni dijelovi, kao i dijelovi zida koji nedostaju / A reconstruction drawing of St. Mark's church. The excavated portions of the foundation walls are marked, as well as presumed portions and the missing portions of the wall (crtež / drawing by Nera Šegvić, Paula Androić, Iva Kostešić; priredila za tisak / design by Iva Kostešić, 2015.)

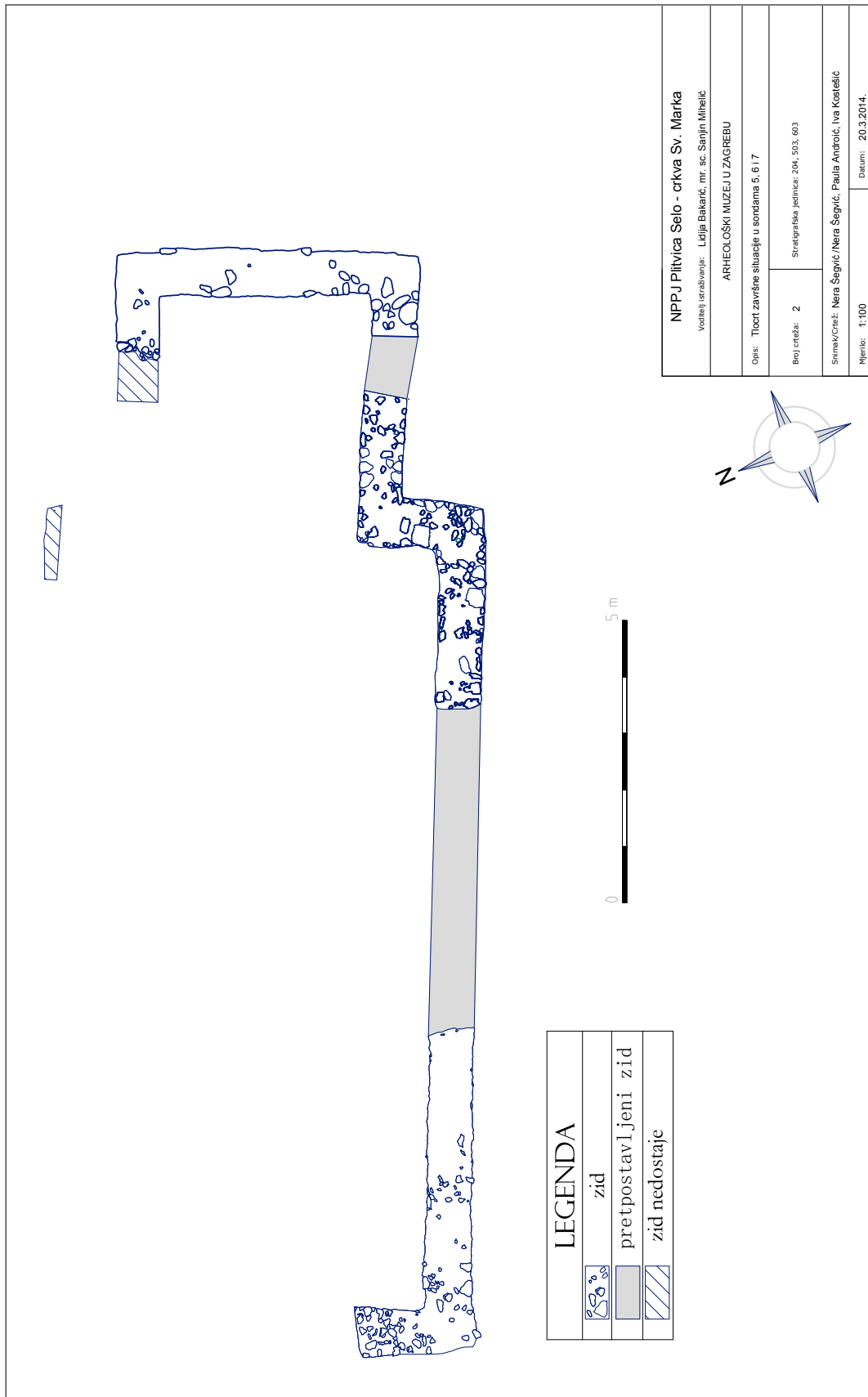
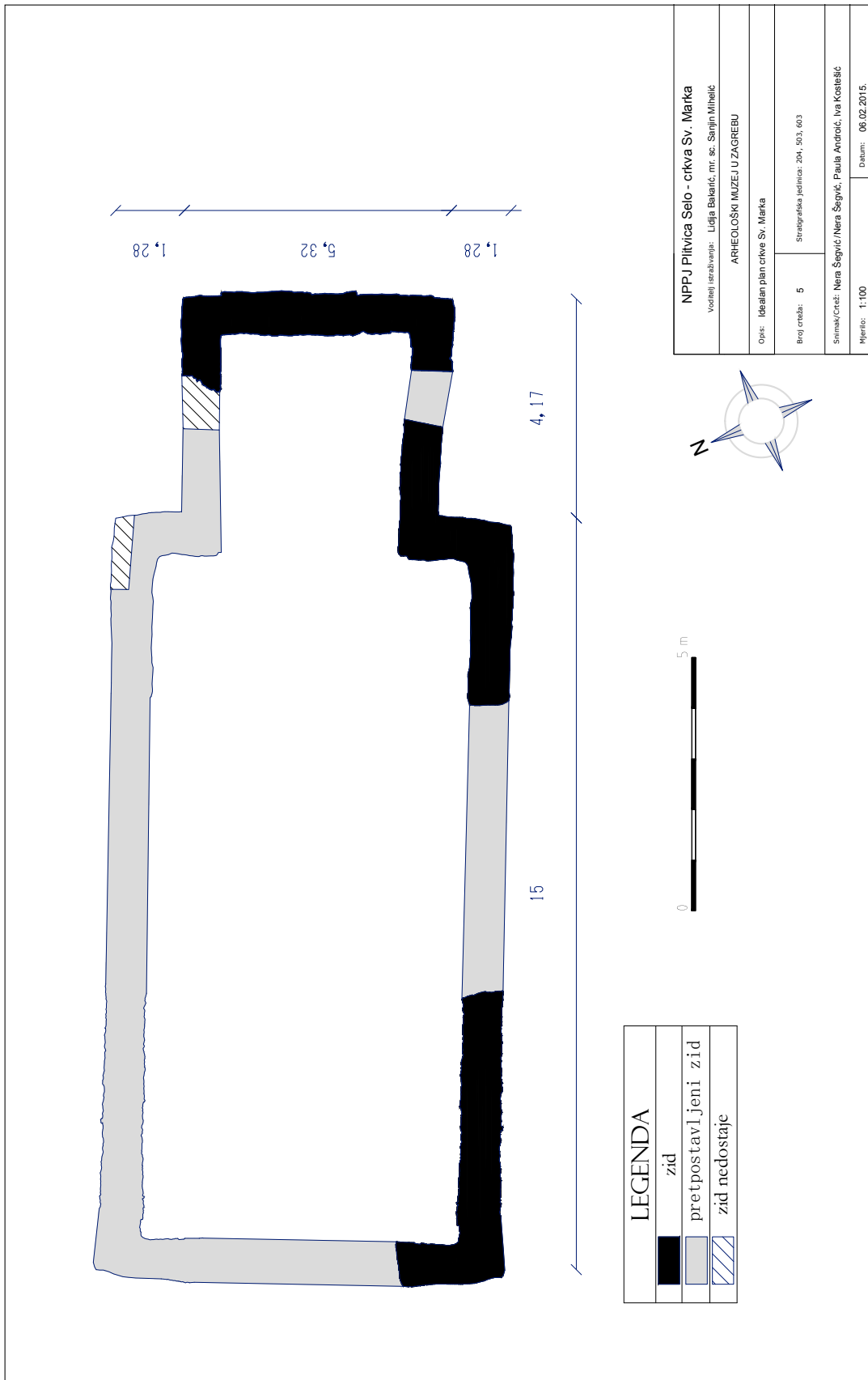